

8. If the trouble still persists:
  - a. Loosen the lock nut A.
  - b. Remove the adjustment screw B.
  - c. Remove the two springs 4 and 16, Fig. 2, the ball seat 15, and the ball 14.
  - d. Clean the valve opening inside the cap 13.
  - e. Replace the parts in the reverse order of (c).
9. If the electric switch on the lid support fails to operate properly:
  - a. Examine the spring 19, Fig. 4, to see that it is properly connected to the switch lever.
  - b. Make certain that the switch lever is not bent, or is not on the opposite side of the ratchet from the pins.
  - c. Remove the switch body 20 from the bracket 18, and examine the switch contacts, making any necessary adjustments.
  - d. Re-assemble the parts.

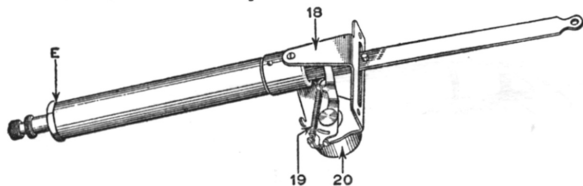

Fig. 4

Name of Part	Part No.
18. Bracket	9302A
19. Spring	4732
20. Switch Body	8336

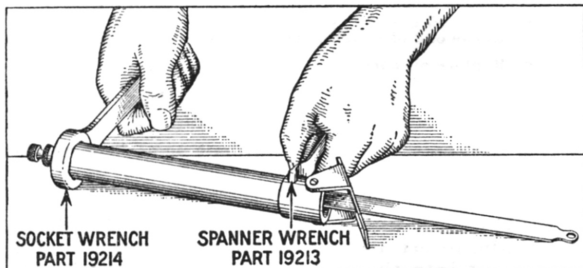

Fig. 5

10. In order to prevent bending of the tube by placing it in a vise, a special spanner wrench, part 19213 and a socket wrench, part 19214, have been made available for removing the cap as shown in Fig. 5.

**IMPORTANT:—**  
**FOR YOUR SERVICE DEPARTMENT.**

Victor Division  
**RCA Victor Company, Inc.**  
Camden, N. J.



**Service Bulletin No. 10**



**AIR LID SUPPORTS**

The air lid supports which are used on the larger Orthophonic Victrolas operate somewhat on the same principle as a bicycle pump. A plunger with a leather washer on the end operates in a tube. When the lid is raised, the weight rests on two ball bearing cups in the tube. As the lid is lowered, the air in the tube below the leather is forced out of a small air vent, the compression taking up the weight of the lid and allowing it to go down slowly.

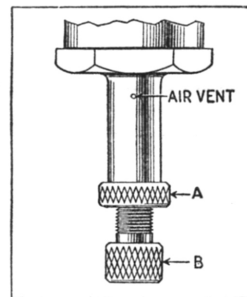

Fig. 1

Should this vent become clogged, difficulty may be experienced in lowering the lid. On the other hand, if the valve opening is too large, or if there is another leak, the lid will go down too fast.

1. If the lid closes too fast:
  - a. Loosen the lock nut A, Fig. 1, and turn the adjusting screw B to the right until proper cushioning has been secured.
  - b. Re-tighten the lock nut.

2. If the lid fails to operate properly after the above adjustment has been made, place a few drops of Neat's-foot oil or other leather preservative in the top of the lid support tube.

**CAUTION:**—Do not use lubricating oil or an excessive amount of Neat's-foot oil.

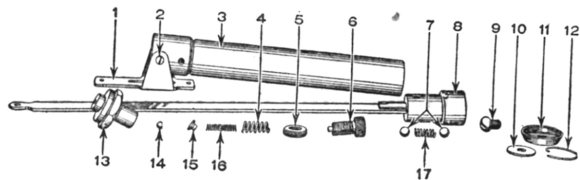

Fig. 2

### PARTS LIST FOR AIR LID SUPPORT

The part numbers of this list with the exception of No. 8 are applicable to all air lid supports. The ratchet No. 8 applies only to the 8-30.

Name of Part	Part No.
1. Bracket	9345
2. Pivot Screw (2 Used)	9304
3. Tube	16417A
4. Spring	15088
5. Lock Nut	15092
6. Adjustment Screw	15091
7. Steel Ball (2 Used)	3658
8. Lid Support Ratchet	15668A
9. Screw	7373
10. Washer	9881
11. Packing Ring	9918
12. Ring Expander	19524
13. Cap	15087
14. Steel Ball	3034
15. Ball Seat	15090
16. Spring	15089
17. Spring	9039

3. If the lid does not operate properly now, after making certain that the oil has worked down the walls of the tube, renew the leather packing washer C, Fig. 3.

- Remove the cap 13, Fig. 2, containing the lock nut 5 and the adjustment screw 6.
- Place the open end of the tube from which the cap was removed down on a table or board.
- Push down the lid support ratchet A, Fig. 3, until access can be had to the screw D.  
NOTE:—Do not push the end of the ratchet out more than  $\frac{1}{4}$ " from the end of the tube as the ball bearings and spring at B will otherwise fall out.
- Remove screw D.
- Remove the metal washer and the ring expander, and place them in the new leather packing washer.



Fig. 3

4. If the old leather washer appears to have been cut, this was likely due to a burr on the inside of the tube at the upper air vent.

- Remove the ratchet from the tube, taking care that the ball bearings and spring at B, Fig. 3, are not lost.
- Clean off the burr with a long file or a wooden plunger to the end of which is attached a piece of emery cloth.
- Replace all parts.

5. If the lid still closes too fast, there is probably leakage around the joint at E, Fig. 4.

- Remove the cap, and distribute some bees wax in the threads of the cap and the tube.
- Replace the cap, and tighten securely.

6. If the lid does not shut entirely, or if it shuts too slowly, insert a small wire or any pointed metal implement into the air vent, Fig. 1. This will remove any dirt that may be clogging the vent.

7. If proper action is not obtained after cleaning the air vent:

- Loosen the lock nut A, and turn the adjustment screw B to the left until proper adjustment is obtained.
- Re-tighten the adjustment screw.